

BETHEL

1 bedroom • 1 bathroom • 644 square feet



Luxury vinyl plank flooring throughout

Large windows for lots of natural light

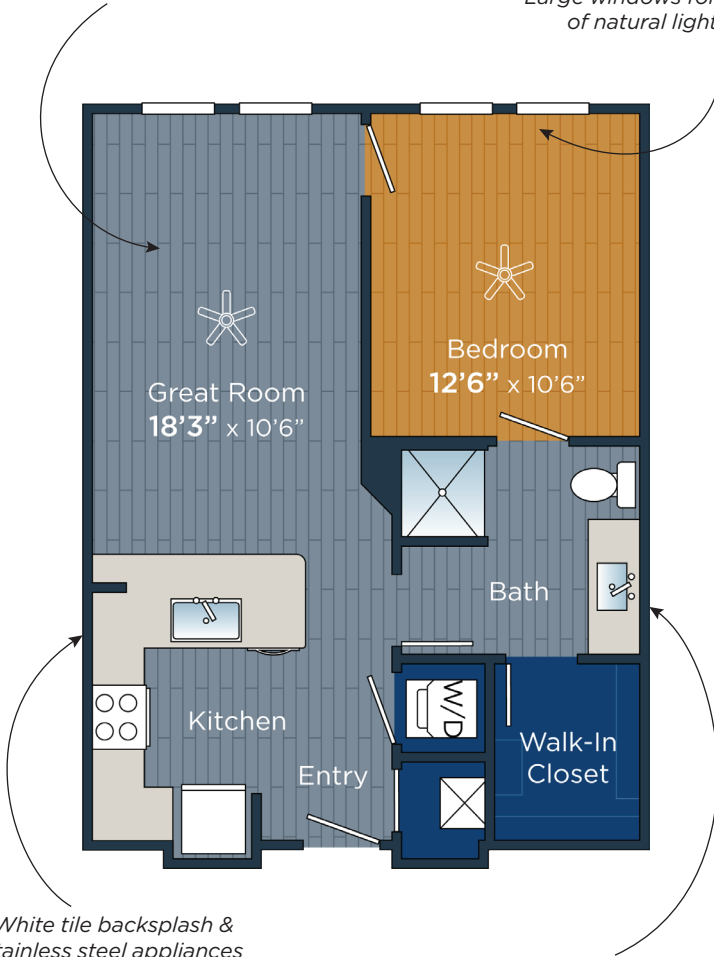

White tile backsplash & stainless steel appliances

Granite countertops in kitchen & bathrooms

1133 Bexley Square • Chattanooga, TN 37410
423.592.8059 • Borough33Apts.com



FEATURES & AMENITIES

LUXURIES

- **BRAND NEW Studio, 1, 2 & 3** bedroom apartment homes
- Kitchens with **granite countertops & subway tile backsplash**
- **Stainless steel GE appliances**
- **Rich vinyl plank style flooring**
- **Walk-in showers** with subway tile & frameless doors*
- **Washer & dryer** in every apartment
- **Stunning balcony views***
- **10' ceilings** on top floor apartments

LOCATION

- Minutes from ample **shopping, dining & entertainment**
- **Quick commutes** to vibrant downtown Chattanooga
- Located a few blocks from **Tennessee Riverpark Wheland Trailhead**
- Less than 2 miles from **St. Elmo Historic District & the Incline Railway**
- Near world-renowned **Lookout Mountain, Ruby Falls & Rock City**

**in select homes*

COMMUNITY

- **Breathtaking clubroom** with inviting fireplace & spacious bar
- **Game room** with shuffleboard, giant wall games & tvs
- **Co-working spaces** in clubhouse
- Resident **coffee lounge & package room**
- **Spacious fitness center** with interactive mirror & yoga room
- **Elevator access** for added convenience
- **Pet spa** with baths and drying areas
- **Resort-style pool** with expansive sundeck & daybeds
- **Covered outdoor entertaining space** with fireplace & grill
- **Brew garden** with fire pits, grills and café lights
- **Outdoor yoga lawn**
- **Bark Park**
- **Electric car charging stations** & free surface parking
- **Garages available**



BOROUGH THIRTY • THREE APARTMENTS

Floor plans and terms are subject to change. Square footage is approximate. All renderings, maps, landscaping, elevations and plans are artist conceptions and are not to scale. The developer/builder reserves the right in its sole discretion to make modifications to maps, plans, renderings, specifications, materials, features or colors without notice. Plans, prices, descriptions and amenities are subject to change without notice.